

ENOITALIA S.r.l.

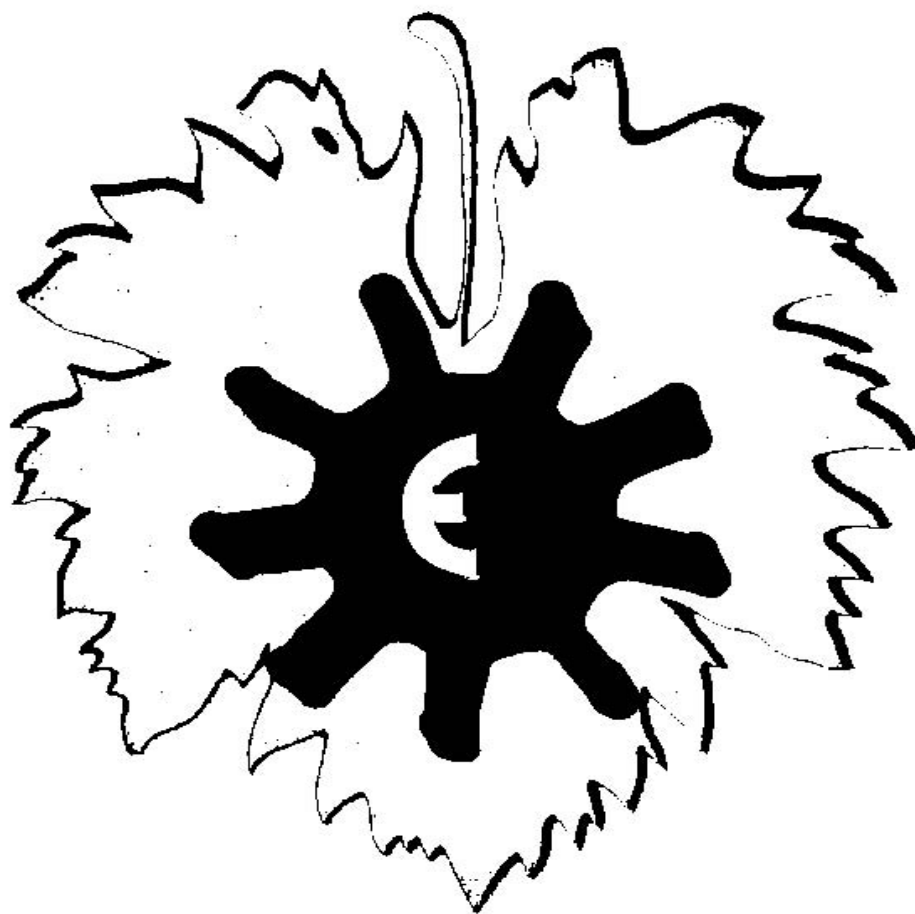

Instructions for use and technical manual

EURO 30 Self Priming Electric Pumps

Enoitalia S.r.l.

Via Provinciale Pisana 162

50050 CERRETO GUIDI - FIRENZE

Tel: +39 (0)571 588031 Fax: +39 (0) 571 588080

www.enoitalia.net

info@enoitalia.net

E. C. DECLARATION OF CONFORMITY

The firm Enoitalia S.r.l. having its registered and operative head office in the borough of Cerreto Guidi (FI), Pieve a Ripoli, in via Prov. Pisana 162 operating in the wine production sector as the manufacturer and retailer of the machinery :
SELF PRIMING PUMPS WITH RUBBER IMPELLERS “EURO 30- 40- 50-60”

DECLARES

That its machinery conforms to the health and safety requirements of the EEC 89/392 Machinery regulations and subsequent additions; and their conformity with regulations:

EN 292-1 Sicurezza del macchinario - Concetti fondamentali, principi generali di progettazione Parte

EN 292-2 Sicurezza del macchinario- Concetti fondamentali, principi generali di progettazione

Parte 2: Specifiche e principi tecnici

EN 294 Sicurezza del macchinario - Distanze di sicurezza per impedire il raggiungimento di zone pericolose con gli arti superiori I: Terminologia, metodologia di base

EN 349 Sicurezza del macchinario - Aperture minime per evitare lo schiacciamento di parti del corpo umano

EN 418 Sicurezza del macchinario - Impianto di arresto di emergenza, aspetti funzionali - Principi per la progettazione

EN 953 Sicurezza del macchinario - Requisiti generali per la progettazione e la costruzione di ripari (fissi, mobili)

EN 954-1 Sicurezza del macchinario - Parti dei sistemi di comando correlate alla sicurezza - Parte I: Principi generali per la progettazione

EN 7346 Rumore emesso da macchine ed impianti - Metodo per la misurazione della potenza sonora.

EN 60204 Impianto elettrico delle macchine - Parte I: Requisiti generali

EN 60947-4-1 Interruttori e comandi a bassa tensione - Parte 4: Contattori elettromeccanici ed avviatori di motori

EN 60947-5-1 Interruttori e comandi a bassa tensione - Parte 5: Dispositivi dei circuiti di comando ed elementi di commutazione - Parte I: Dispositivi elettromeccanici dei circuiti di comando.

IEC 227-1 Cavi isolati con cloruro di polivinile con voltaggi nominali fino a 450/500 V - Parte I: Requisiti generali

IEC 245-1 Cavi isolati con gomma con voltaggi nominali fino a 450/750 V- Parte I: Requisiti generali

UNI 9456 Macchine Agricole- Ripari e schermature – Definizioni e prescrizioni

A manual of instructions for use is supplied with the above said machinery for its correct use and the correct performance of maintenance or repair operations without risk.

This self priming electric pump with a rubber impeller is suitable for decanting delicate liquids of an alimentary type even where particles in suspension are present (like wine, milk, oil, stemmed grapes, fruit juices), and a vast range of chemical substances.

The electric pump can rotate in either direction. The main part of the pump is made entirely from AISI 304 stainless steel or, upon request from AISI 316, while the impeller is made entirely from rubber for alimentary use (Certificate N° 2218 dated 05/11/98; N° 2218/b dated 05/11/98; N° 2844 dated 30/11/98 in accordance with the D. M. dated 21/03/73 and D. M. n° 220 dated 26/04/93).

In all the models the pump is easy to open so that normal cleaning and maintenance procedures can be carried out by qualified personnel.

Some models are equipped with BY-PASS: a valve in AISI 304 stainless steel situated on the main part of the pump which enables the flow to be adjusted as desired.

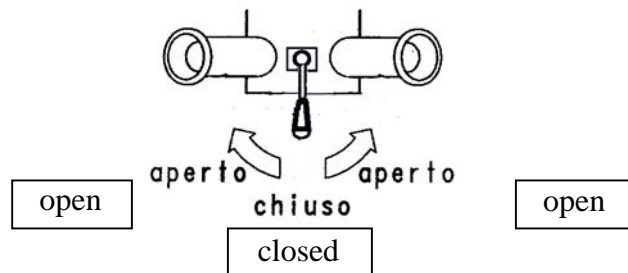

The electric pump is composed of the following components:

- MOTOR with stainless steel shaft
- TROLLEY (except for Euro 20)
- PUMP SUPPORT
- RUBBER IMPELLER
- SHAFT IN STAINLESS STEEL AISI 304 or AISI 316 in models Euro 50 and Euro 60

2. POSITIONING, TESTING AND INSTALLATION

The electric pump should be firmly positioned on a stable surface horizontal to the ground. The level of the liquid to be decanted should be at a maximum depth of not more than 5/6 metres from the center axis of the pump. The suction intake should be at least 10- 15 cm below the level of the liquid.

Before installing check the following: Before plugging in the machine, confirm that the voltage of the motor (or the frequency drive) corresponds with that supplied at the mains and that the switch is turned to the OFF (0) position. The electrical safety of this machine is only guaranteed where the electrical installation has been efficiently grounded, in accordance with current regulations. Testing and any installation of necessary electrical components must be carried out by qualified personnel. The use of adaptors or multiple sockets is not recommended; when they are essential only use products conforming to current safety regulations, and respect the maximum supply in terms of current and power.

Attaching hoses: the hoses should be of the rigid, reinforced type and should be attached to the pump using the special adjustable metal bands, avoiding excessive tightening which would produce a restriction of the hose and prevent a steady flow of the liquid. Before turning on the machine and attaching the hoses the main part of the pump should be filled up to half its capacity with the liquid to be decanted.

IMPORTANT: never turn on the machine when empty (without any liquid in it). The first time the machine is used it should be given a preliminary wash to remove any residues which might have remained after manufacturing.

3. FUNCTIONING

The self priming EURO electric pumps are powered by electric motors (manufactured in the full respect of all current safety regulations), the switch of which, when the machine is off, should always be turned to OFF or “0”

To turn on the machine: turn the switch to the desired speed or to the “1” position in models where speed regulation is not provided. The intake of the pump which will suck up the liquid to be decanted, is determined by the direction of rotation of the impeller, which can be determined by observing the rotation of the fan visible at the back of the machine.

Once the pump has been turned on, it should be primed in a few seconds. If more than 10 seconds pass without this happening, then you must turn off the motor, disconnect the power supply and check that the hoses have been properly attached or that there are no holes in the feed hose since this could cause an infiltration of air.

If the machine is equipped with a by-pass, then this valve can be adjusted to regulate the flow as desired, increasing it (valve closed) or decreasing it (valve open).

IMPORTANT: when starting the pump, the by-pass must be closed; for the suction of solid particles the by-pass must always be closed.

To turn the machine off just turn the switch to “OFF” or “0”

In the event of an emergency stop then turn the machine on again in the opposite direction then immediately invert the direction so as to eliminate particulates which might hinder the rotation of the impeller.

4. WASHING AND MAINTENANCE

After use, the machine should be washed so as to maintain its mechanical and hygienic features. Allow the machine to operate for a few minutes with clean water, then empty the hoses and the main part of the pump completely of any water. If you do not plan to use the pump for some time, then pour a few drops of glycerine oil (or food grade lubricant) into the pump before turning it on for a few seconds.

Maintenance: all the parts of the pump are checked and adjusted in the factory before packing. For this reason the machine does not require any special maintenance, but just needs periodic checks which will also make it last longer.

IMPORTANT: Such periodic inspections should be carried out by qualified personnel with the machine unplugged.

The following aspects should be checked:

- wear and tear of the impeller
- check sealing orings
- check bearings

In the event repairs are necessary, only use original spare parts ordered from the retailer or directly from the manufacturer.

Possible causes of malfunctioning

PROBLEM	REMEDY
The pump isn't exerting enough pressure	Check the state of wear and tear of the impeller.
Liquid is leaking from the main part of the pump	Check and if necessary replace the sealing orings
Liquid is leaking from the flange of the motor or the support of the pump	Check and if necessary replace the sealing orings
Breakage of one or more fins of the impeller	Replace the impeller with an original spare part ordered from the retailer or directly from the manufacturer
It's difficult to get the machine started.	Check that the machine is getting enough power from the mains. Don't use extension cords which might cause a lowering of the voltage.

5. WARNINGS

- Store the machine in a dry place, where it is not exposed to bad weather and protect it from getting damp
- Do not use the machine for decanting inflammable or explosive liquids or in an explosive environment, since the motor is not anti-deflagration.
- The temperature of the liquids being decanted should be between +5 °C and 65 °C; higher temperatures would compromise the general performance of the impeller.
- Before turning on the machine check that it has not been damaged during transport (breakage or dents).
- Never plug it in, turn it on or perform any other operation on the electrical parts with wet hands
- Do not remove the protective guard (on the models where it is provided) while the machine is in use, or while washing
- Before using the machine carefully read this manual, and keep it safely for future reference
- The firm Enoitalia S.r.l. is not liable for damage deriving from modifications made by others to the machinery.
- The firm Enoitalia S.r.l. reserves the right to make manufacturing modifications at any moment without being obliged to make these public.

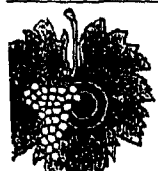
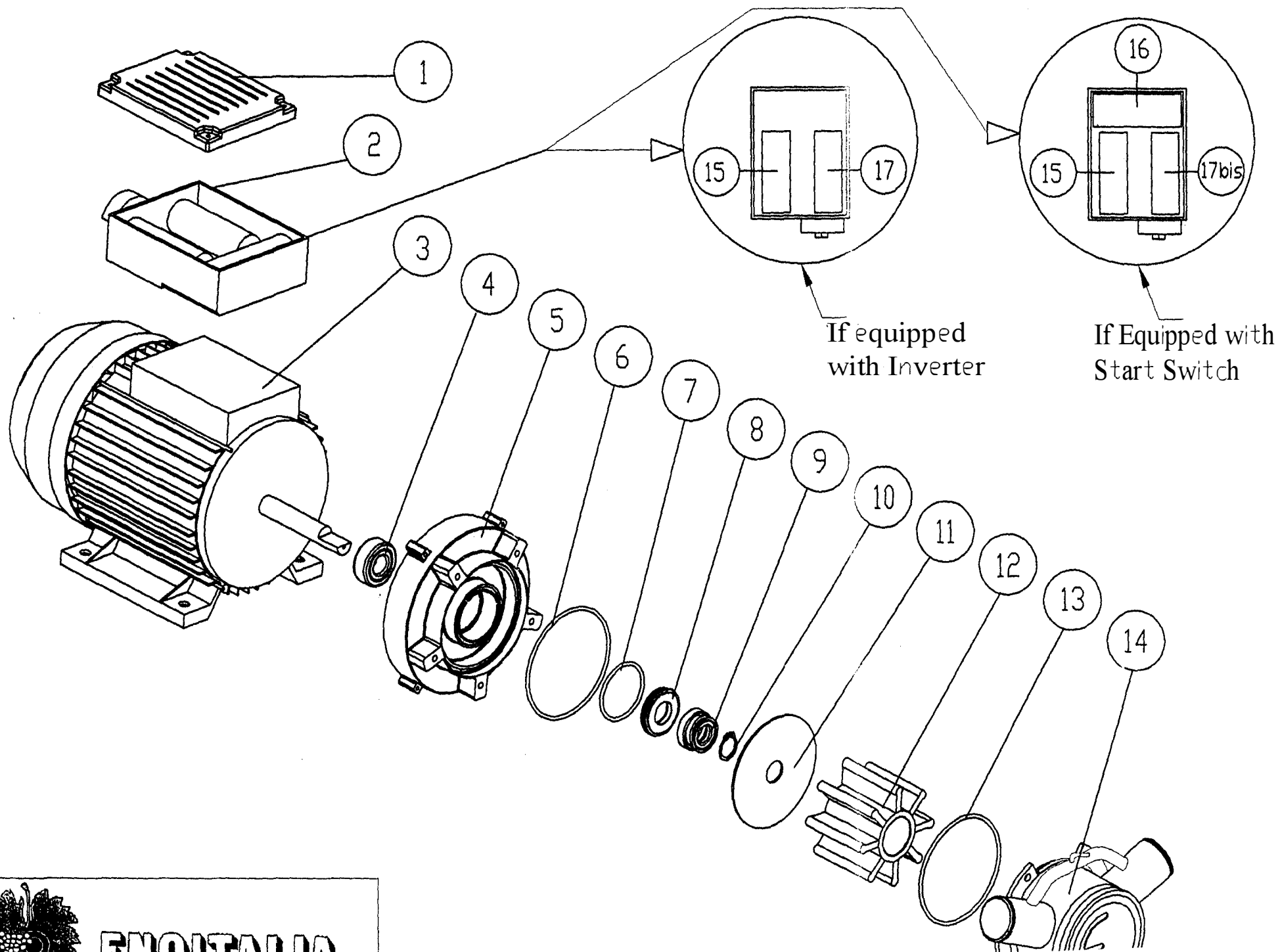

ENOITALIA s.r.l.