

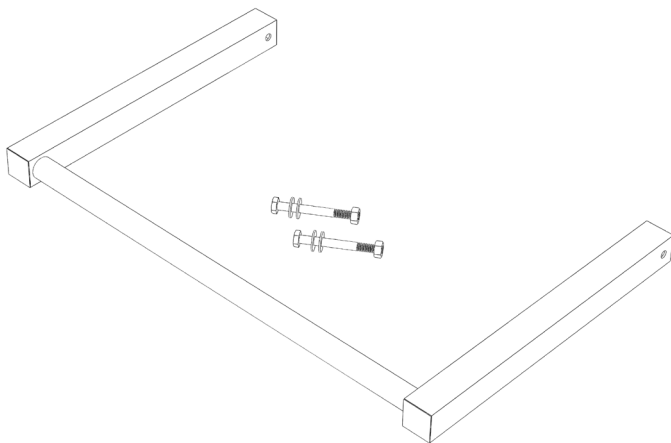

**BrewBuilt™**



**HANDLES**

# HANDLE:

## Recommended Tools:

7/16" or 11mm Socket Wrench, and 7/16" or 11mm Combination Wrench.



BrewBuilt™

- 1 Open package and ensure that you have all required parts. Your package should have included:

- a Handle
- b Hardware Set, including 2x Mounting Bolt, 2x Locknut, 6x Flat Washers

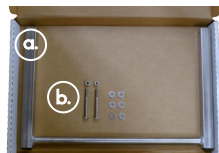

- 2 Locate the mounting holes on the top of the legs of the burner. Note that the handle can mount to either the left or right side of the frame.



- 3 Install the mounting bolts through the handle and frame legs from the outside. The Flat washers should go between the bolt head and the outside of the burner leg, between the inside of the burner leg and the handle, and between the inside of the handle and the Lock Nut. Thread the Lock Nuts on as far as you can by hand.



- 4 Use the Combination Wrench to hold the Lock Nuts in place and tighten down the bolt heads with the Socket Wrench.



- 5 Check to ensure that the handle can fold up and down easily. If it is too tight or rubs on the leg weld, loosen the Lock Nuts a little at a time until you are happy with the handle tension and clearance.

